

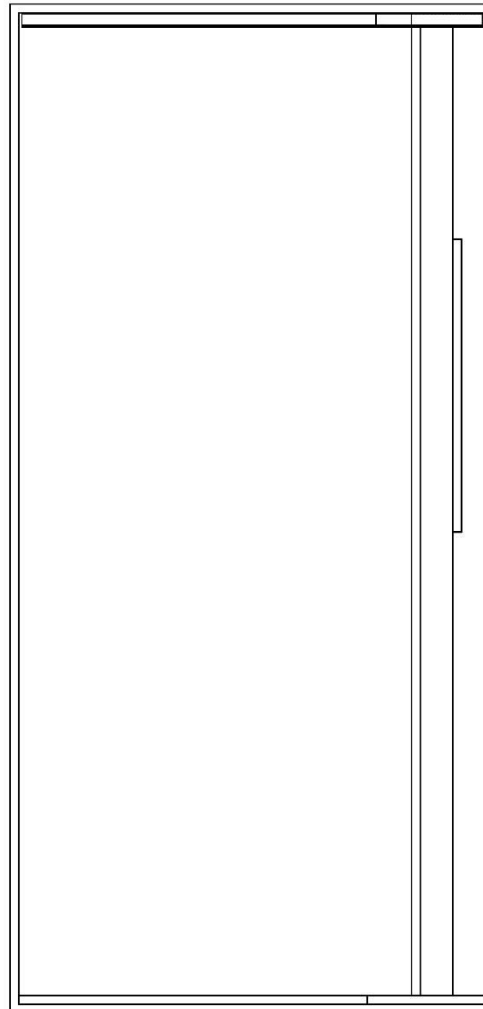

**ROCKY MOUNTAIN
ELEVATOR PRODUCTS**
LIVE LIFE ELEVATED

CAB BUILDERS GUIDE FOR THE RMEP WRAP AROUND GATE



Contents

INTRODUCTION	3
GATE HEIGHT AND CAB HEIGHT	3
GATE HANDING	4
WRAP GATE/CAB FOOTPRINT	5
MODIFIED FOOTPRINT	6
NARROW TRACK OPTION	6
DESIGNERS NOTES	7

INTRODUCTION

The RMEP Wrap Around Gate is an ASME 5.3.1.7.2 (2016) compliant gate. There are some requirements for proper cab design to work with the RMEP Wrap Around Gate. These will be outlined in this manual.

GATE HEIGHT AND CAB HEIGHT

Due to the nature of the manufacturing and assembly process, we cannot simply cut gates to any size. Therefore, it may be necessary to install a drop header to install the gate that is closest but not over the cab height. See Figure 1.

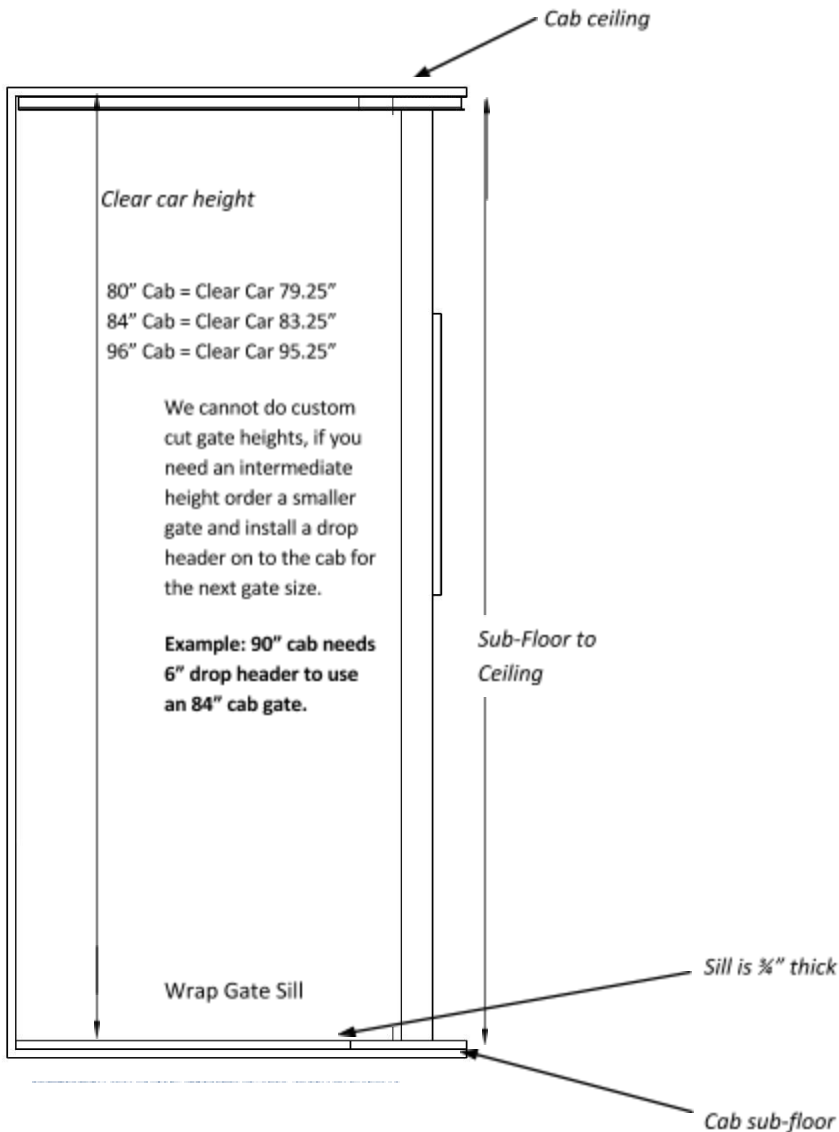

GATE HANDING

The RMEP Wrap Around Gate is designed to be left or right handed with no modifications necessary. The lead and tail post are the same design, the only requirement is that the gate is installed so the folding action is in the same direction as the corner. The Wrap Around Gate only folds one direction and cannot wrap “backwards”. Therefore it is important to note the direction the gate folds when installing on the cab. ***NOTE: The gate is generally symmetrical inside to outside, the only notable difference is the hinge reliefs.**

Lead and Tail posts are the same.

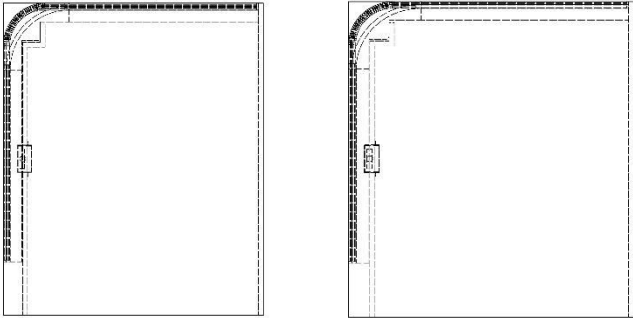

WRAP GATE/CAB FOOTPRINT

FRONT OF CAR

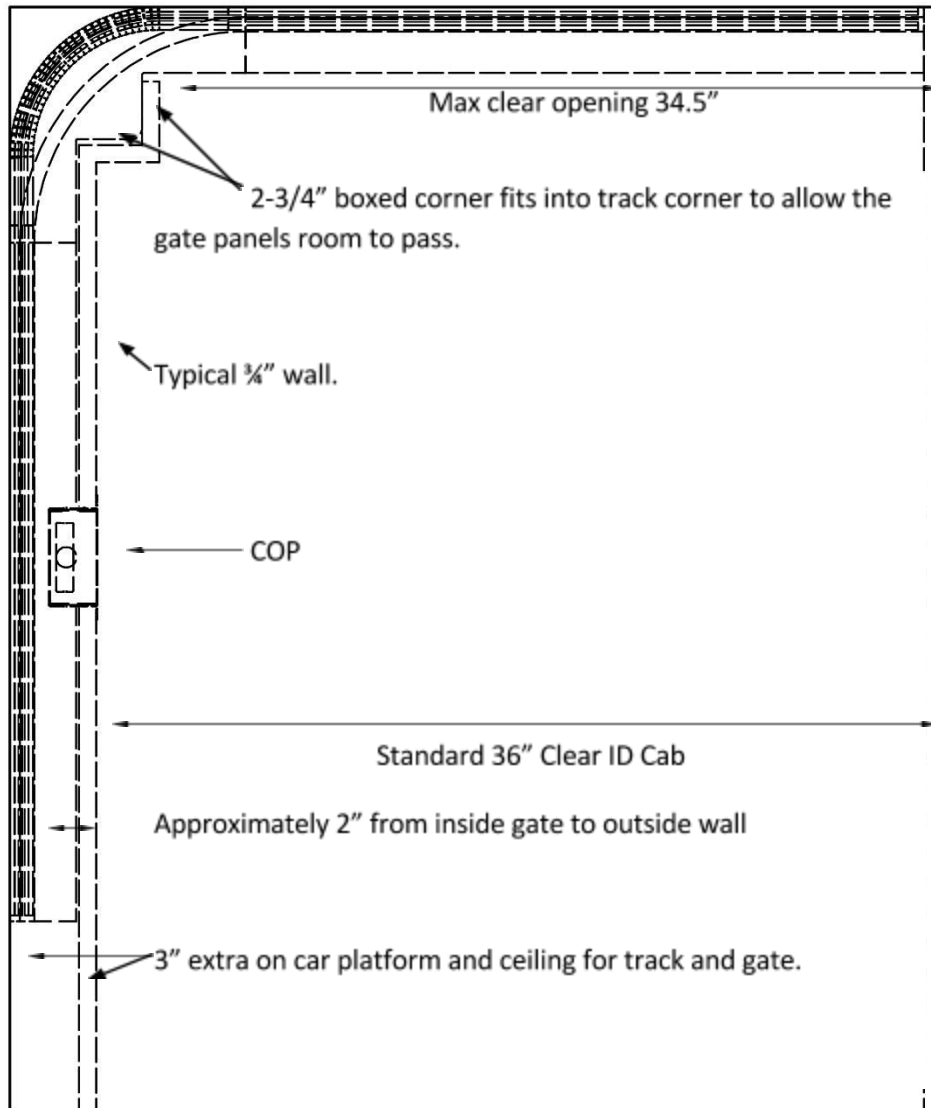

Figure 4 Basic footprint. Looking down from the top of the car/cab.

MODIFIED FOOTPRINT

Top track imposed for reference.

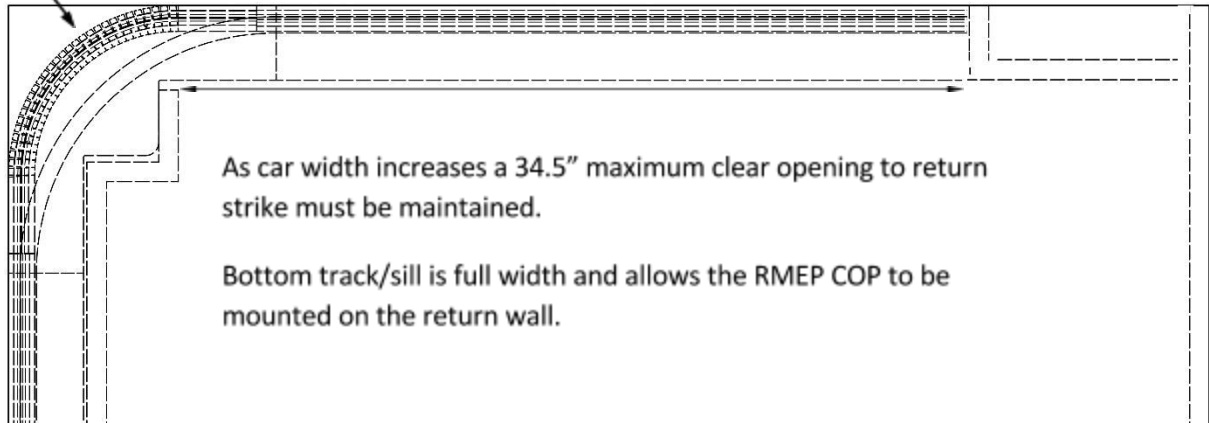
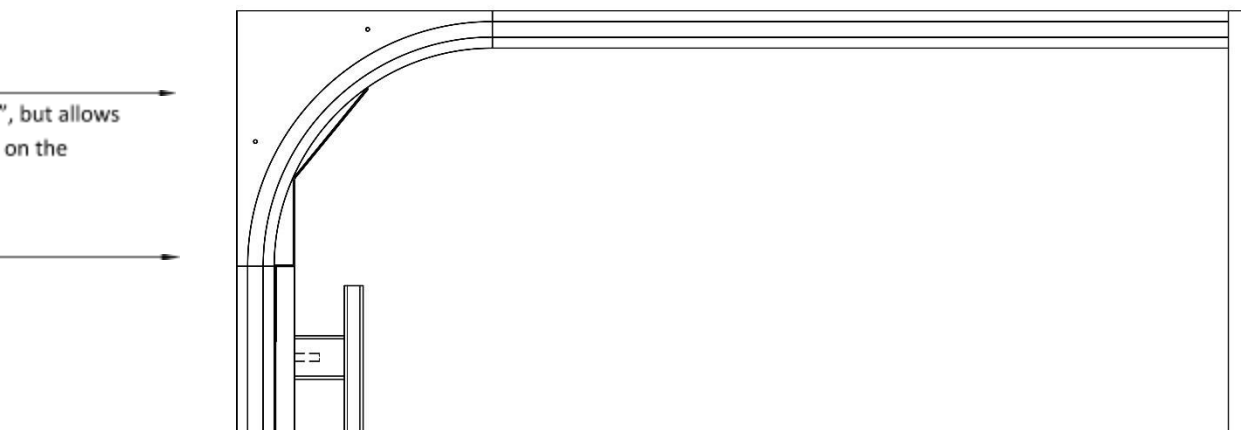

Figure 5. Modified footprint, close strike.

NARROW TRACK OPTION

Top Track not shown for clarity of image.



DESIGNERS NOTES

Use this page to make notes or questions.

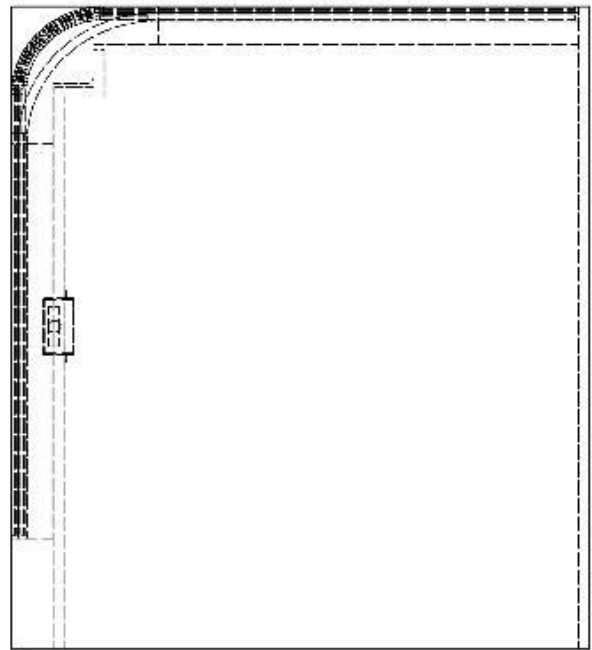
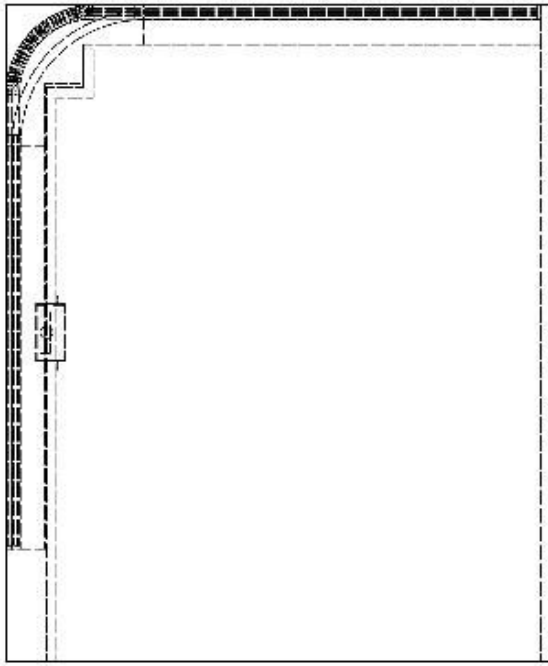

80" Cab = Clear Car 79.25"

84" Cab = Clear Car 83.25"

96" Cab = Clear Car 95.25"

**Example: 90" cab needs
6" drop header to use an
84" cab gate.**